

UNIVERSALLY ACCESSIBLE KAYAK AND CANOE LAUNCH

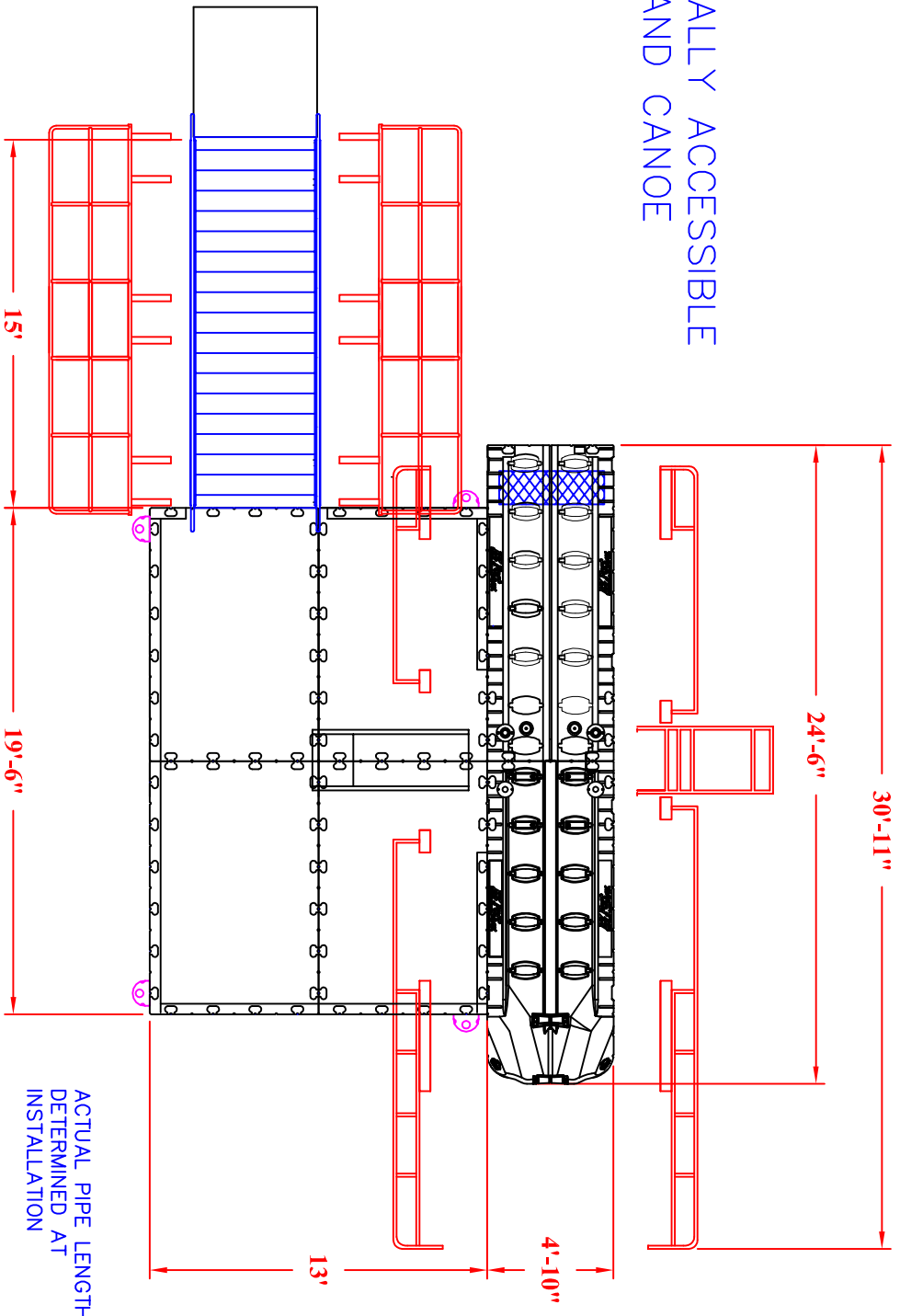

BILL OF MATERIALS

Part No.	Description	Qty.	Part No.	Description	Qty.
208010	80" x 10" DOCK SECTION	4	112025	2-3/8" OD x 12" LONG GALV PIPE	4
206030PW	PORT MAX ENTRY	1	100255	2-1/2" ALUM AUGER	4
206031PW	PORT MAX EXTENSION	1	100026	2-1/2" PIPE CAP	4
301100	COUPLER SET	20	130250	2-1/2" PIPE BRACKET	4
301208	PORT TO PORT COUPLER SET	1	G-6015EE	5' x 15' ALUM GWAY	1
G-0118	KAYAK / CANOE BOW STOP	1	G-115EE	15' ALUM GWAY RAILS (PAIR)	1
500900R	LAUNCH RAIL - RIGHT HAND ENTRY	1	G-600EE	15' ALUM GANGWAY BRACKET	1
500901R	LAUNCH RAIL - EXTENSION RIGHT	1	G-6000	5' ADA TRANSITION PLATE	1
500890	TRANSFER STATION w/ RAIL	1	300300	GANGWAY ROLLER KIT	1
100757SS	ADU ADAPTER DOCK TO LAUNCH	2	105035	3" SCH 80 x 56" LONG PVC ROLLER	1
35116	SECURITY CURBING	6			
80530SS	SECURITY CURBING SCREWS	42			

*** ALL MEASUREMENTS
ARE APPROX. ***

ACTUAL PIPE LENGTH
DETERMINED AT
INSTALLATION

NOTICE: Read EZ Dock Limited Warranty carefully.
Among other things, EZ Dock does not warrant damages,
failures or defects caused by unauthorized modification
of EZ Dock Product and/or unauthorized attachment to/of
EZ Dock Product.

DESCRIPTION: RICHFIELD TWP, UNIVERSALLY ACCESSIBLE
CANOE and KAYAK LAUNCH

PREPARED FOR: B & L SHORELINE
SCALE: NONE
DRAWN BY: DK

DATE: 3/17/11
DRAWING # 100566
EZ DOCK OIM
1382 E. Caro Rd.
Caro, MI 48723
PH 800-252-4448
FAX 989-673-2109